

We Make Solar Evolve

ELITE MONO

Monocrystalline Module

ETM315-60



Rich Product Portfolio & Innovative Product Strategy, satisfy customer needs to the best, and keep the customers' overall costs to the lowest.



High Conversion Efficiency

Industry-leading processing techniques realize great module efficiency to a maximum of 19.38%, steady power output guaranteed.



Anti-reflective Coating and Reduce O&M Costs

Easier to clean by rainwater to remove dirt on the glass surface, making higher power output and lower maintenance costs.



0 to +5W Positive Tolerance

Gain more power yields than expected.



Excellent Loading Capability

Test load: 2400Pa wind loads, 5400Pa snow loads. Durable and long-lasting.



Top-quality & Trustworthy Product

Rigorous Quality Management System built. Multiple internationally recognized PV industry standard certifications attained.

LINEAR PERFORMANCE WARRANTY

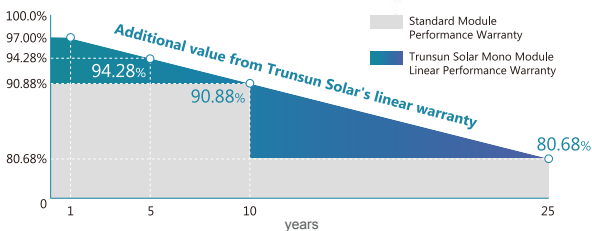

25 25-years Linear Performance Warranty

10 10-years Product Material & Workmanship



ELECTRICAL SPECIFICATIONS (STC)

Model Type	ETM315-60
Peak Power (Pmax)	315W
Module Efficiency	19.38%
Maximum Power Voltage (Vmp)	33.8V
Maximum Power Current (Imp)	9.32A
Open Circuit Voltage (Voc) ±3%	40.72V
Short Circuit Current (Isc)±3%	9.84A
Power Tolerance	0 to +3%
Operating Temperature	- 40 ~ + 85°C
Maximum System Voltage	DC 1000V
Nominal Operating Cell Temperature	42±3°C
Fire Safety	Class C
Maximum Series Fuse Rating	15A

ELECTRICAL SPECIFICATIONS (NOCT)

Model Type	ETM315-60
Peak Power (Pmax)	234W
Maximum Power Voltage (Vmp)	31.12V
Maximum Power Current (Imp)	7.50A
Open Circuit Voltage (Voc)	38.41V
Short Circuit Current (Isc)	7.95A

MECHANICAL SPECIFICATIONS

Cell Type	Mono-Crystalline ,6' inch
Number of Cells	60pcs(6×10)
Weight	18.2kg
Dimension	1640×991×35 mm
Front Cover	3.2mm Tempered Glass
Frame	Anodized Aluminium Alloy
Junction Box	IP67, 3 Bypass Diodes
Cable Type	4mm ²
Length of Cable	1000mm
Connector	Jiaming: PV-JM601
Origin	China

PHYSICAL CHARACTERISTICS Unit:mm (inch)

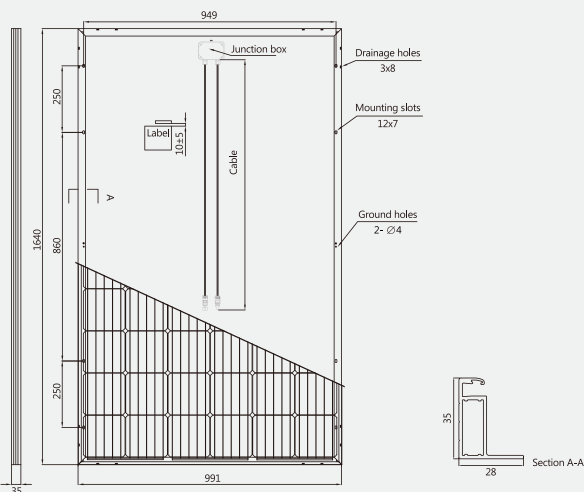

TEMPERATURE COEFFICIENT

Temp. Coeff. of Isc (TK Isc)	0.05% /°C
Temp. Coeff. of Voc (TK Voc)	-0.31% /°C
Temp. Coeff. of Pmax (TK Pmax)	-0.40% /°C

PACKING MANNER

Container	40' HQ
Piece/Pallet	30
Pallet/Container	28
Piece/Container	840

ELECTRICAL CHARACTERISTICS

Current-Voltage Curve under different irradiance

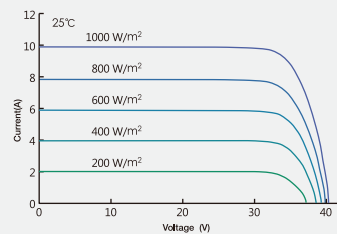

Current-Voltage Curve under different working temperatures

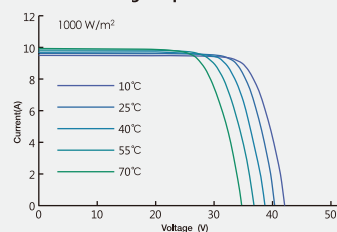

Note: the specifications are obtained under the Standard Test Conditions (STCs): 1000 W/m² solar irradiance, 1.5 Air Mass, and cell temperature of 25°C. The NOCT is obtained under the Test Conditions: 800 W/m², 20°C ambient temperature, 1m/s wind speed, AM 1.5 spectrum.

Please contact support@etsolar.com for technical support. The actual transactions will be subject to the contracts. This parameters is for reference only and it is not a part of the contracts. The specifications are subject to change without prior notice.